



DOUBLE BAG

ORDER INFORMATION SHEET

FSPN-250

FILTER SPECIALISTS, INC.

100 Anchor Road P.O. Box 735 (46361) Michigan City, Indiana 46360
 219-879-3307 800-348-3205 Fax: 219-877-0632 www.fsifilters.com

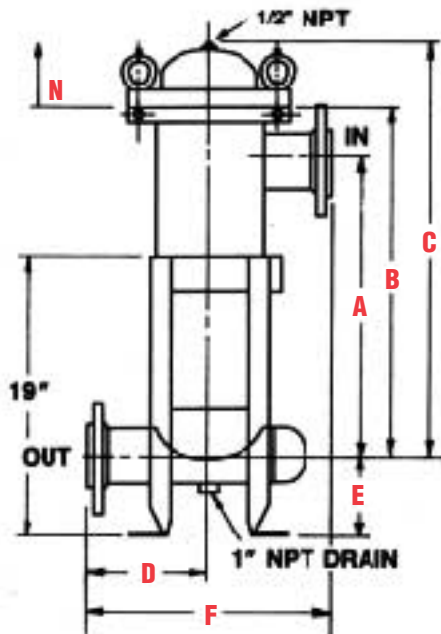

STYLE 6

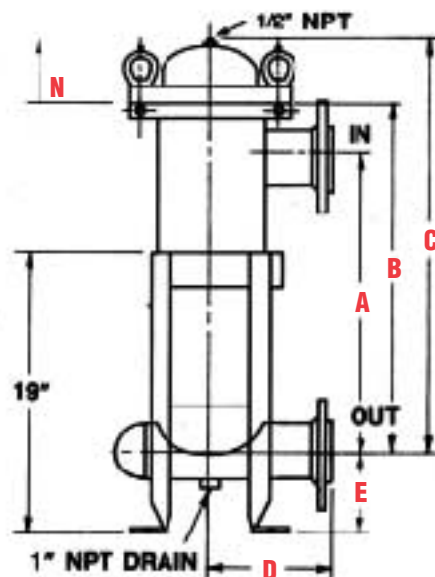

STYLE 8

- NOTES:**
- 1) Design: ASME Code Section VIII, Div. 1, UM Stamp standard, U stamp and National Board optional.
 - 2) Custom-designed models of these units can be provided for most operating requirements on special order.
 - 3) Flow rate is dependent on type of media, particle selection required, fluid viscosity and volume of contamination.
 - 4) 1/2" NPT Inlet Drain (not shown)

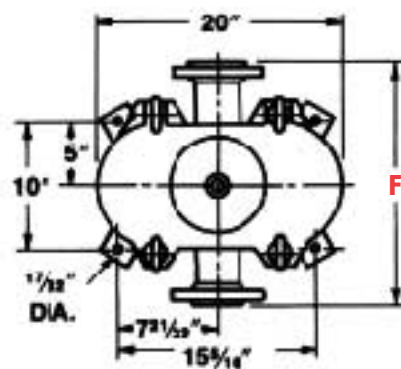

STYLE	NO. BAGS	A	B	C	D	E	F	N MIN. CLEAR. TO REMOVE BAGS
3" FLG	2	25 5/8"	30 1/2"	35 3/4"	9 1/2"	*	19"	30"
4" FLG	2	25 5/8"	30 1/2"	35 3/4"	9 1/2"	*	20"	30"
4" FLG STYLE 8	2	25 5/8"	30 1/2"	35 3/4"	10 1/2"	*	N/A	30"

* Adjustable

ORDER INFORMATION Check appropriate boxes

Design Pressure: 150 PSIG 300 PSIG Other _____

Design Temperature (F°): Max _____ Min _____

Construction Material: Carbon Steel 304 Stainless Steel 316 Stainless Steel Other _____

Basket Materials: 304 Stainless Steel (Standard) 316 Stainless Steel Other _____

Gasket Material: BUNA N (Standard) Viton Neoprene EPR Teflon Encapsulated Other _____

Lifting Mechanism: Hinge is standard Other _____